

Project 1: Thematic Map

Due Wednesday, September 21, 2016

You are to create a map of the School that can be used to guide someone from my classroom to the Science Hall and Staple it to this form.

You must include the following;

- 1) Numbers to all Classrooms and labels to rooms not used to teach
- 2) All the 4 parts of a map are included
 - a. Title
 - b. Legend = Subject Categories
 - c. Compass Rose
 - d. Scale: 1 in=30ft
- 3) Color the classroom by Subject taught in that room
 - a. Social Studies
 - b. Language Arts
 - c. Science
 - d. Math
 - e. Fine Arts/Electives
 - f. Administration/Councilor

You May use the Map on the back as your final but I will deduct 10 points for not drawing it.

Project Grading Rubric:

Score	Requirements
0	The student doesn't complete the map.
25	The student completes the map but provides none to 1 of the 4 parts of the map.
50	The student completes the map and provides the 2 of the 4 parts of the map.
75	The student completes the map and provides the 3 of the 4 parts of the map.
100	The student Completes the map and provides all 4 parts of the map.

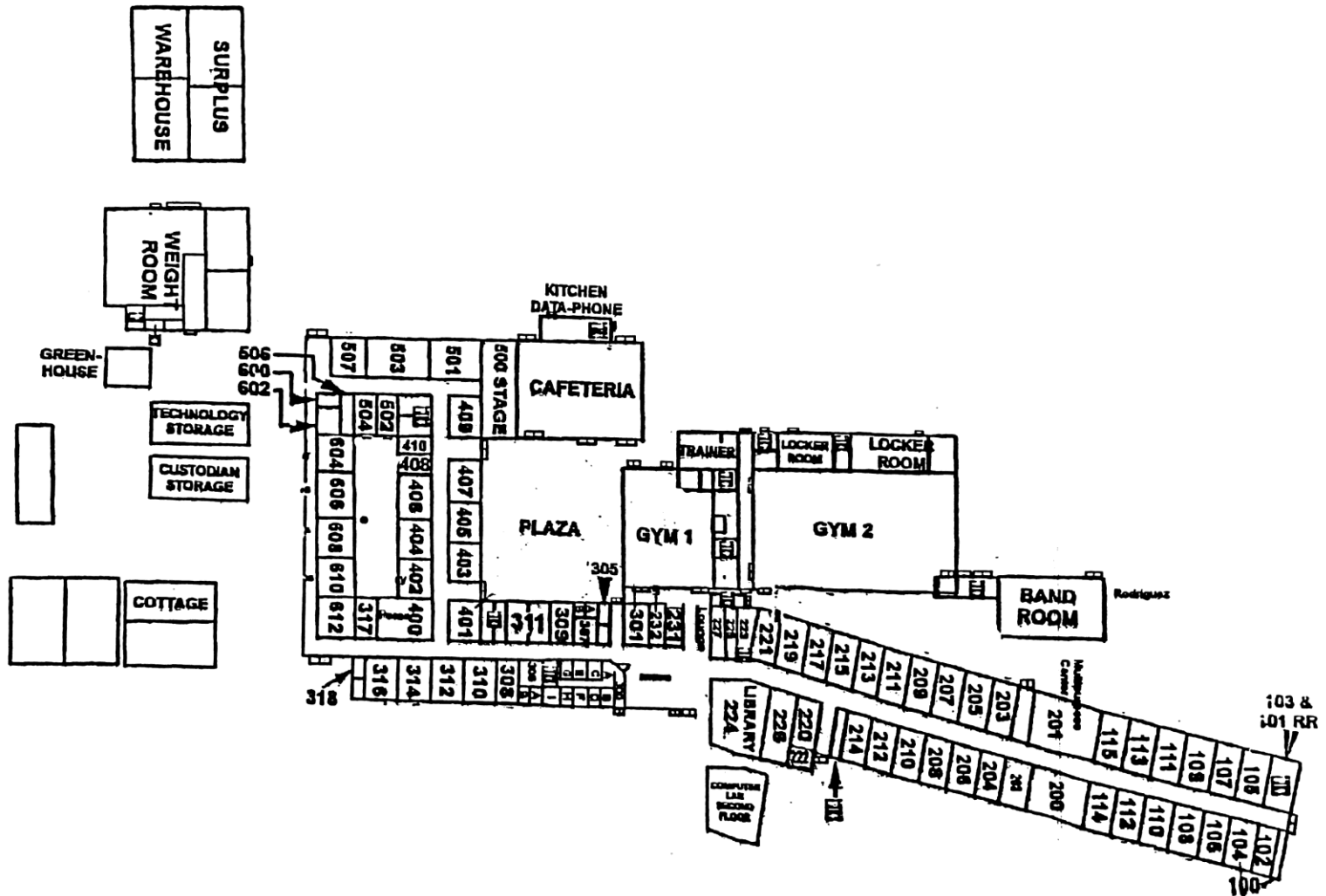

* Math Bldg. is North.